

Truss Technology

IN BUILDING

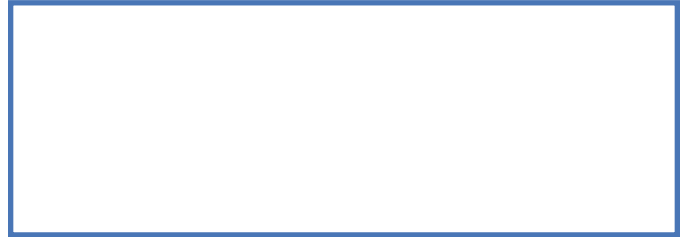

Floor Truss Fact Sheet

Builders are discovering that floor trusses are the solution to many of their floor framing problems. Floor truss installations create high quality, squeak-free construction with the added benefits of reduced framing time, waste, pilferage and callbacks. Design versatility and open web spaces are tremendous advantages to builders of today's complex and sophisticated homes.

- The fact that floor trusses are built with 2x4s or 2x3s oriented 'flatwise' means a wide, stable bearing surface that is easier to work on and around.
- The wide nailing surface provides for easy gluing and quick, accurate attachment of sheathing, reducing squeaks and improving floor performance for the life of the structure.
- Spacing floor trusses at 19.2" or 24" o.c. maximizes structural efficiency and speed of installation.
- Stiffness and strength can be designed into the floor truss, creating a more solid floor.
- Special bearing, cantilever and balcony details are easily built in.
- Shrinkage, warping or twisting are minimized, reducing the potential for callbacks to the job site.
- Long spans and girder truss options reduce the need for intermediate bearing walls, beams, columns or footings saving time and construction costs.
- The open web configuration leaves plenty of room for plumbing, electrical, and mechanical runs.
- Typical depths for floor trusses are 12" to 24" but shallower or deeper configurations are possible.



Some products can be end-trimmed on site in case bearing conditions are not perfect. Visit the WTCA web site for manufacturers of these products.



While floor trusses may cost more per lineal foot, overall you save more money due to reduced installation time and wasted material. The Framing the American Dream™ project showed how efficiently a trussed floor could be installed on a 2,600 sq. ft. house:

	HOURS TO FRAME	QUANTITY OF LUMBER
Stick Frame	38 hours	4,256 board ft
Floor Truss	12 hours	3,147 board ft
USING FLOOR TRUSSES SAVES	26 HOURS	1,109 BOARD FT



STANDARD STRUCTURAL DETAILS

These are some of the standard floor truss installation details are available for download on the WTCA web site.

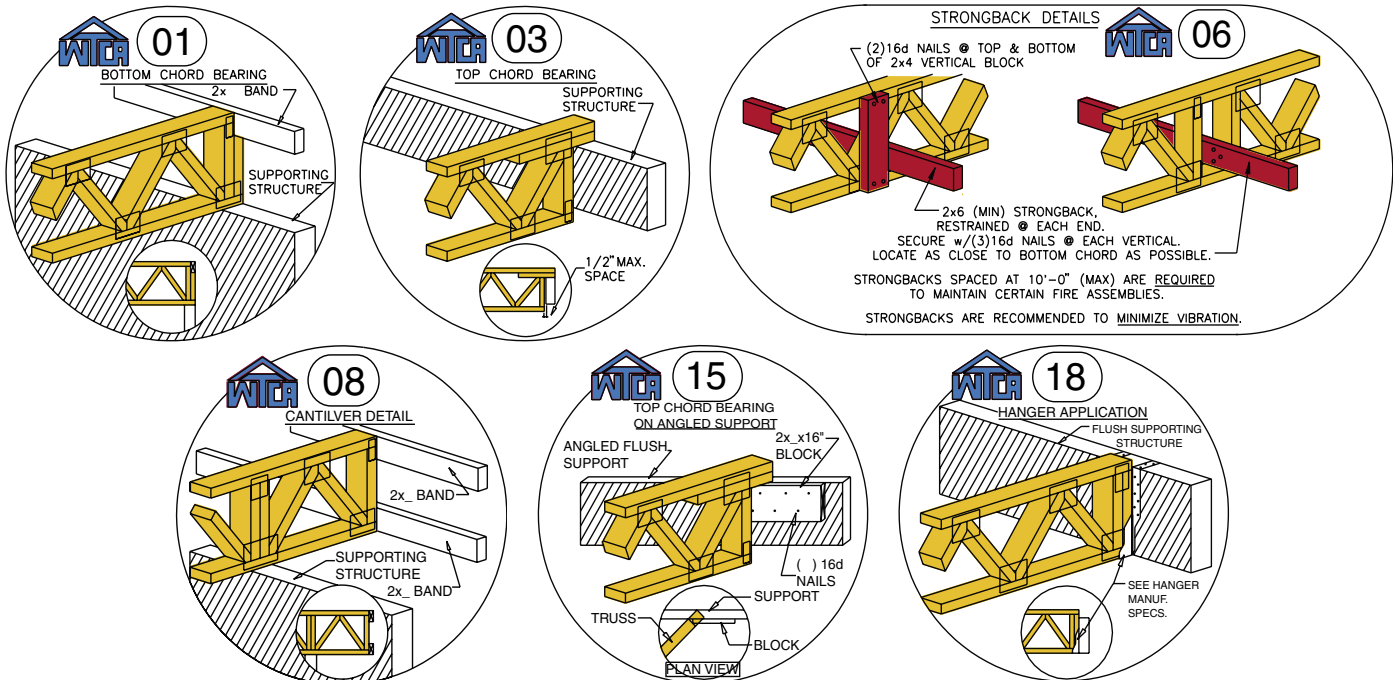

Wood Truss Council of America

One WTCA Center
6300 Enterprise Lane • Madison, WI 53719
608/274-4849 • 608/274-3329 fax
www.woodtruss.com • wtca@woodtruss.com



An informational series designed to address the issues and questions faced by professionals in the building construction process.

Copyright © 1999-2003 Wood Truss Council of America, Inc. All Rights Reserved.

Reproduction of this document, in any form, is prohibited without written permission from WTCA. This document should appear in more than one color.

Disclaimer

This copyrighted document is a secure PDF, and while it can be opened, saved and emailed, it cannot be printed. To order copies or receive a complimentary hard copy, contact the WTCA at 608/274-4849.